

Cladding Power Stripper (CPS Series)

Rev 11

Description

The Cladding Power Stripper (CPS) is designed for efficiently stripping off residual cladding power, ASE and escaped core modes of double cladding fiber while preserving minimal degradation to signal power and beam quality.

Key Features

- High Power Handling
- Minimal Signal Loss

Applications

- High Power Fiber Laser
- High Power Fiber Amplifier

Specifications

Parameter	Unit	Value			
Operating Wavelength Range ¹	nm	800 - 2000			
Min. Stripping Efficiency ²	%	98			
Max. Signal Insertion Loss	dB	0.3			
Fiber Type for Input and Output		10/130 DCF or 20/130 DCF or 30/250 DCF			
Max. Stripped Power	W	20	50	200	800
Package Type	mm	P2	P5	P7	P8
Operating Temperature	°C	- 5 to + 60			
Storage Temperature	°C	- 40 to + 85			

¹Represents the wavelength of the main light in the cladding which is requested to be stripped by the device.

²Fully filled condition.

Package Dimensions

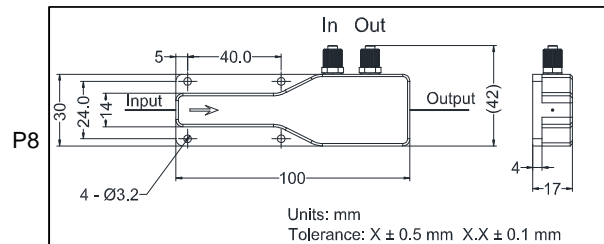
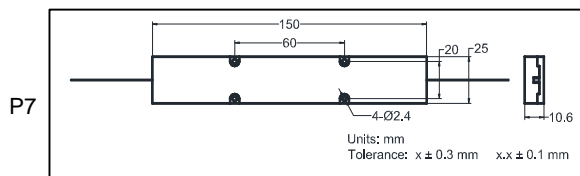
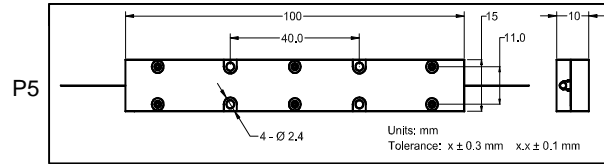
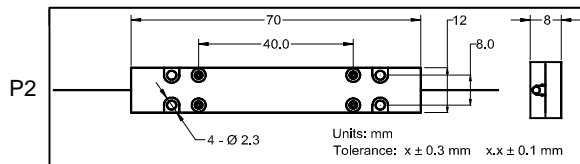

Ordering Information

CPS-①①①-②②②②-③③-④④④-⑤-⑥

①①①: Operating Wavelength

915 - 915 nm

975 - 975 nm

SSS - Specify

②②②②: Signal Wavelength

1064 - 1064 nm

1550 - 1550 nm

SSSS - Specify

③③: Fiber Type

10 - 10/130 DCF

20 - 20/130 DCF

30 - 30/250 DCF

SS - Specify

④④④: Stripped Power

020 - 20 W

050 - 50 W

200 - 200 W

800 - 800 W

⑤: Package Type

2 - P2: 70 (L) × 12 (W) × 8 (H)

5 - P5: 100 (L) × 15 (W) × 10 (H)

7 - P7: 150 (L) × 25 (W) × 10.8 (H)

8 - P8: 100 (L) × 30 (W) × 17 (H) (Water Cooling)

⑥: Fiber Length

Q - 0.75 m

S - Specify