



BrightLase® Single Emitters

Applications

- Laser pumping: Solid state lasers, Fiber lasers
- Materials Processing: Marking, Soldering, Plastics welding
- Medical: Dental, Ophthalmology, Therapeutic
- Printing: Computer to plate, Flexography
- Defense: Ordinance initiation, Illumination

Features

- 2.5 W, 50 μm device
- 5 W, 100 μm device
- 808 nm, 976 nm, and 1050 nm
- C-mount conduction cooled mounts

Benefits

- Highest performance from solid state lasers due to industry leading brightness and power
- Increased throughput for printing applications from industry leading power and brightness
- Longer working distance, simpler optical design
- Long term spectral stability and device reliability via hard solder and CTE matched mounting technology



	4203-C	4204-C	4205-C	4304-C	4404-A
Center Wavelength	808 nm	808 nm	808 nm	976 nm	1050 nm
Wavelength Tolerance	±3 nm	±3 nm	±3 nm	±3 nm	±10 nm
Spectral Width (FWHM)	<4 nm	<4 nm	<3 nm	<6 nm	<6 nm
Output Power	2.5 W	5 W	8 W	5 W	5 W
Operating Current	<3.25 A	<6.5 A	<10 A	<7.5 A	<7.5 A
Operating Voltage	<2.1 V	<2.1 V	<2.1 V	<1.8 V	<1.7 V
Threshold Current	< 0.7 A	<1.2 A	<2 A	<1.0 A	<1.0 A
Slope Efficiency	>0.95 W/A	>0.95 W/A	>0.95 W/A	>0.75 W/A	>0.75 W/A
Conversion Efficiency	>40 %	>40 %	>40 %	>40 %	>40 %
dλ/dT	0.3 nm/°C	0.3 nm/°C	0.3 nm/°C	0.3 nm/°C	0.3 nm/°C
Slow Axis Divergence (FWHM)	<10 deg.	<10 deg.	<10 deg.	<10 deg.	<10 deg.
Fast Axis Divergence (FWHM)	<40 deg.	<40 deg.	<40 deg.	<35 deg.	<35 deg.
Emitter Width	50 μm	100 μm	200 μm	100 μm	100 μm
Polarization	TE	TE	TE	TE	TE
Operating Temperature	25°C	20°C	20°C	20°C	20°C
Mount Type	C-mount	C-mount	C-mount	C-mount	C-mount
Height* x Length x Thickness	6.68 x 6.30 x 3.60 mm	6.68 x 6.30 x 3.60 mm	6.68 x 6.30 x 3.60 mm	6.68 x 6.30 x 3.60 mm	6.68 x 6.30 x 3.60 mm
Chip Bonding	p-down, AuSn	p-down, AuSn	p-down, AuSn	p-down, AuSn	p-down, AuSn

* Height is defined from the bottom of the C-mount to the emitter axis

BRIGHTNESS and POWER
Breaking Performance Barriers through Semiconductor Laser Innovation

QPC Lasers, Inc.

15632 Roxford Street • Sylmar, CA 91342 • Phone: +1 (818) 986-0000 • Fax: +1 (818) 698-0428
 www.QPClasers.com • email: info@QPClasers.com





QPC Lasers, Inc.

BrightLase® Single Emitters

C-Mount

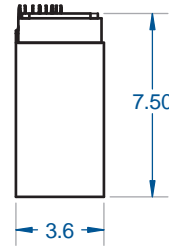
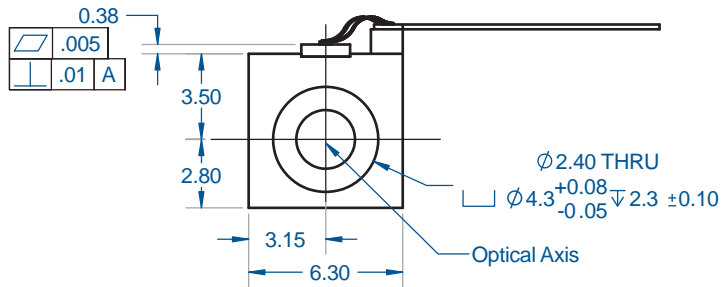
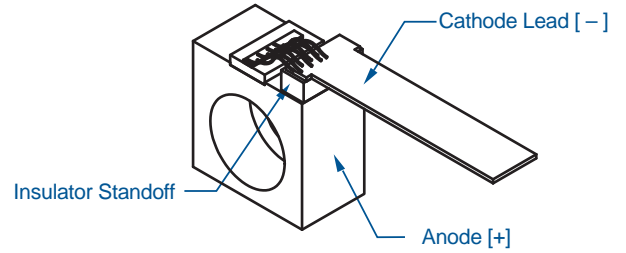
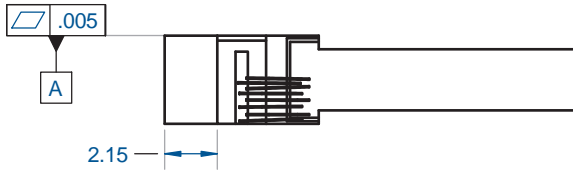

光技術をサポートする

株式会社オプトサイエンス

<http://www.optoscience.com>

東京本社 〒160-0014 東京都新宿区内藤町1番地 内藤町ビルディング
 TEL: 03 (3356) 1064 FAX: 03 (3356) 3466 E-mail: info@optoscience.com
 大阪支店 〒532-0011 大阪市淀川区西中島7-7-2 新大阪ビル西館
 TEL: 06 (6305) 2064 FAX: 06 (6305) 1030 E-mail: osk@optoscience.com
 名古屋営業所 〒450-0002 名古屋市中村区名駅2-37-21 東海ソフトビル
 TEL: 052 (569) 6064 FAX: 052 (569) 8064 E-mail: ngo@optoscience.com

BRIGHTNESS and POWER
Breaking Performance Barriers through Semiconductor Laser Innovation

QPC Lasers, Inc.

15632 Roxford Street • Sylmar, CA 91342 • Phone: +1 (818) 986-0000 • Fax: +1 (818) 698-0428

www.QPCLasers.com • email: info@QPCLasers.com