



Gooch & Housego



QX Series KD*P Pockels Cell

QX1020 / QX1320 / QX1630 / QX2035

The QX series sets the standard for KD*P electro-optic Q-switches. These devices provide reliable, stable performance for a diverse range of laser applications, from <300nm to 1100nm.

We offer a unique rebuild program that extends the QX lifetime. All rebuilt units are upgraded with the latest product improvements and are returned with a new one-year warranty.

The standard configuration employs a broad band, high damage threshold Sol Gel AR coating for improved durability and performance. The QX series is also available with index matching fluid and a choice of end caps. All units are tested for optic and electric function and are supplied with a QA inspection report and suggested alignment procedures.

Performance Data

Typical Specification 99% KD*P	QX1020	QX1320	QX1630	QX2035
<u>Physical:</u>				
Hard aperture diameter	9.25 mm	12.3 mm	15.1 mm	19.5 mm
Single Pass Insertion Loss	<1.4%	<1.4%	<1.8%	<2.0%
Voltage Contrast Ratio				
(Cross polarizers)	5000:1	4000:1	3500:1	3000:1
(Parallel polarizers)	2500:1	1500:1	1800:1	1600:1
Single Pass Distortion @ 633nm	< $\lambda/8$	< $\lambda/8$	< $\lambda/8$	< $\lambda/8$
<u>Electrical:</u>				
Capacitance @ 1 kHz	6pF	9pF	9pF	13pF
DC Quarter wave voltage @1064nm	3.2 kV	3.5 kV	3.3 kV	3.5 kV
10-90% Rise time (50 Ω line)	0.8 ns	1.1 ns	1.1 ns	1.5 ns

Note: Specifications are subject to change without notice.



光技術をサポートする

株式会社オプトサイエンス

<http://www.optoscience.com>

東京本社 〒160-0014 東京都新宿区内藤町1番地 内藤町ビルディング
 TEL:03(3356)1064 FAX:03(3356)3466 E-mail:info@optoscience.com
 大阪支店 〒532-0011 大阪市淀川区西中島7-7-2 新大阪ビル西館
 TEL:06(6305)2064 FAX:06(6305)1030 E-mail:osk@optoscience.com
 名古屋営業所 〒450-0002 名古屋市中村区名駅2-37-21 東海ソフトビル
 TEL:052(569)6064 FAX:052(569)8064 E-mail:ngo@optoscience.com



Features

- Industry and time proven performance
- Dry SolGel type or IM fluid-filled
- Highest (99.8% KD*P) deuteration levels in industry available
- Adhesive/Epoxy-free assembly
- Premium UV-grade fused silica windows
- Apertures from 9.25mm diameter up to 19.5mm diameter
- Lowest absorption in industry
- High-reliability
- Economical upgrade/rebuild program
- Highest optical damage resistance
- Accessible technical support
- Standard performance documentation
- One-year limited warranty
- Operation up to 10kHz (special order)

To order: specify model, wavelength, endcap style (DT, TK, TN) and net window wedge (0° or 1°) and dry /fluid style

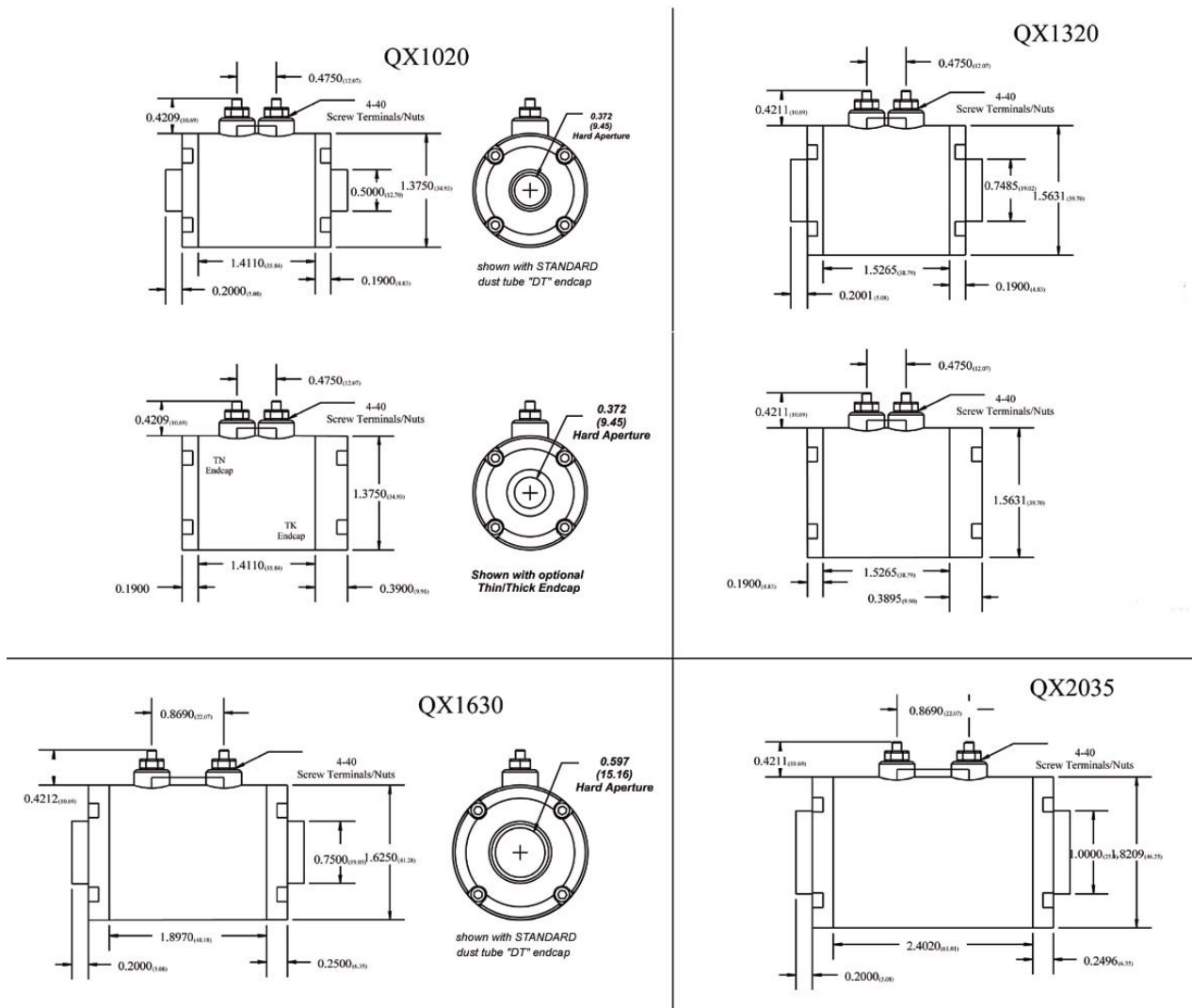

Contact:

Sales@GoochandHousego.com

www.GoochandHousego.com