



Gooch & Housego



LightGate Series BBO Pockels Cell

LightGate BBO Pockels cells are the preferred alternative to KD*P Pockels cells for high-average power and high repetition rate applications. The LightGate series BBO Pockels cell employs dual crystal geometry to minimize drive voltage (~3.4kV quarter-wave voltage @ 1064nm for 4mm aperture LightGate 4). BBO is transparent from approximately 0.2 to 2.1mm and is not subject to tracking degradation. It also shows low piezoelectric ringing, which is useful for repetition rates of hundreds of kilohertz. LightGate Pockels cells are useful for regenerative amplifiers and in high pulse repetition rate micro-machining lasers and high-average power lasers for material processing and metal annealing. G&H also offers special single crystal cells, extra-long, reduced voltage cells and cells attenuated for ultra-low ringing, for special applications

Features

- High Repetition Rate
- Low Acoustic Noise
- Damage Resistant Ceramic Apertures
- High Average Power Applications
- Compact design
- Suitable for Q-switch and Regen-amp Applications
- Lower Voltage Requirements Than Other BBO Cells

Typical Performance:

ICR VCR	>2500:1 >500:1
Apertures	3.25mm, 4mm, 5.5mm & 7mm
Spectral range of operation	~200-2100nm (must specify single wavelength of operation)
Single Pass Optical Transmission	>98%
DC quarter-wave Voltage Capacitance	2.8KV, 3.4KV, 4.4KV & 5.4KV 4pF (all)
Transmitted Wavefront Error	< $\lambda/6$

As part of our policy of continuous product improvement we reserve the right to change specifications at any time



光技術をサポートする

株式会社オプトサイエンス

<http://www.optoscience.com>

東京本社 〒160-0014 東京都新宿区内藤町1番地 内藤町ビルディング
TEL:03(3356)1064 FAX:03(3356)3466 E-mail:info@optoscience.com
大阪支店 〒532-0011 大阪市淀川区西中島7-7-2 新大阪ビル西館
TEL:06(6305)2064 FAX:06(6305)1030 E-mail:osk@optoscience.com
名古屋営業所 〒450-0002 名古屋市中村区名駅2-37-21 東海ソフトビル
TEL:052(569)6064 FAX:052(569)8064 E-mail:ngo@optoscience.com

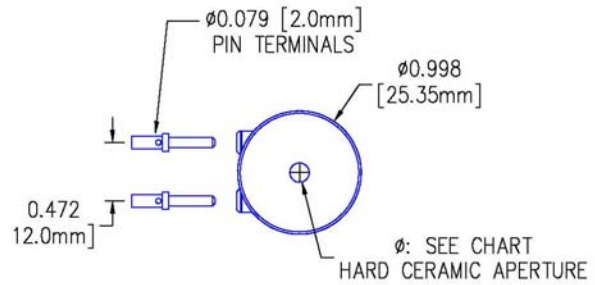
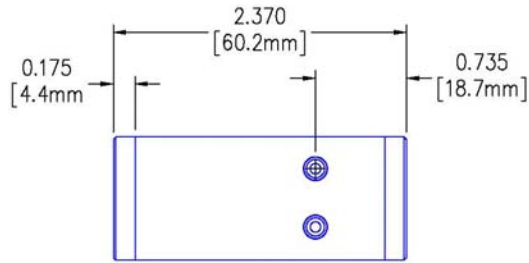

LIGHT GATE SERIES
LG Standard Model
BBO Pockels Cell

MODEL	CLEAR APERTURE ϕ
LG3	0.128 [3.2]
LG4	0.157 [4.0]
LG5	0.217 [5.5]
LG7	0.276 [7.0]

Contact:
Sales@GoochandHousego.com

www.GoochandHousego.com